



Reynolds, Smith and Hills Inc.

2600 Park Tower Dr, Suite 101
Vienna, Virginia 22180
703-549-2472
www.rsandh.com
Virginia Registration Nos. 0407-003171 * 0411-00438



MANASSAS REGIONAL AIRPORT
MANASSAS, VIRGINIA

AIRPORT LAYOUT PLAN

CONSULTANTS

REVISIONS

NO.	DESCRIPTION	DATE

DATE ISSUED: 10/2024

REVIEWED BY: LO

DRAWN BY: TJM, BJM

DESIGNED BY: TJM, BJM

PROJECT NUMBER
1022-1886-004

© 2024 RS&H, INC.

SHEET TITLE
INNER PORTION OF THE APPROACH SURFACE RUNWAY 34L

SHEET NUMBER

14 OF 20

DESCRIPTION	EXISTING
PROPERTY LINE	---
PART 77 SURFACE	PT77
APPROACH SURFACE	APP
DEPARTURE SURFACE	DEP
PAPI OBSTACLE CLEARANCE SURFACE	---
VERTICAL GUIDANCE SURFACE	---
OBSTRUCTION	● 30000

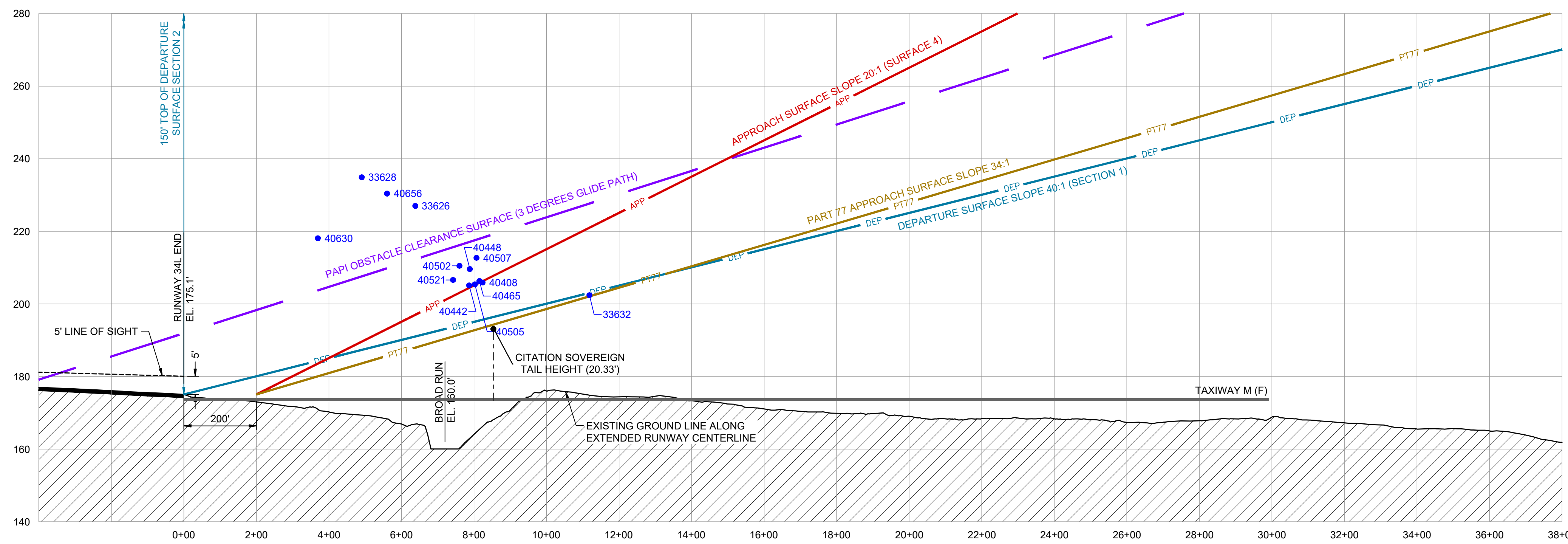
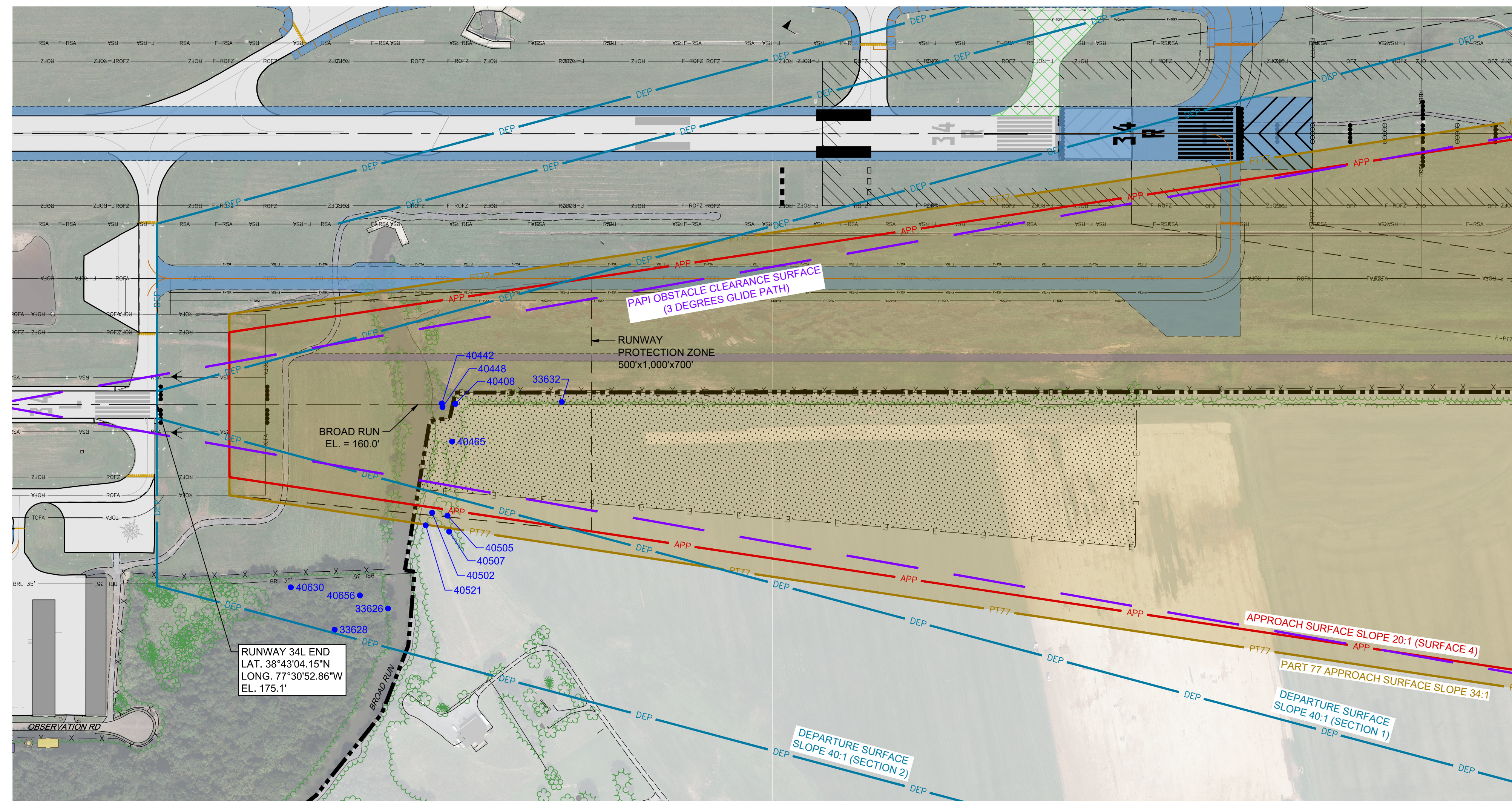

NOTES:
1. ROADWAY ELEVATIONS INCLUDE TRAVERSEWAY ADJUSTMENT (23' RAILROADS | 17' HIGHWAYS | 15' PUBLIC ROADS | 10' PRIVATE ROADS).

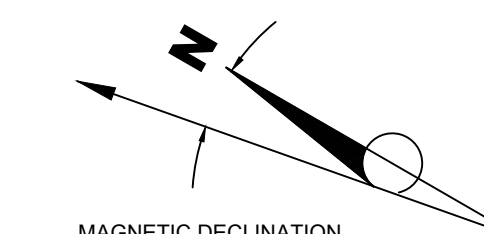

MAGNETIC DECLINATION
10° 27' WEST
JULY, 2022
ANNUAL CHANGE 0° 0' WEST

