



**Reynolds, Smith and Hills Inc.**

2600 Park Tower Dr, Suite 101  
Vienna, Virginia 22180  
703-549-2472  
www.rsandh.com  
Virginia Registration Nos. 0407-003171 \* 0411-00438



**MANASSAS REGIONAL AIRPORT**  
MANASSAS, VIRGINIA

**AIRPORT LAYOUT PLAN**

**CONSULTANTS**

**REVISIONS**

NO.	DESCRIPTION	DATE

DATE ISSUED: 10/2024

REVIEWED BY: LO

DRAWN BY: TJM, BJM

DESIGNED BY: TJM, BJM

PROJECT NUMBER  
**1022-1886-004**

© 2024 RS&H, INC.

SHEET TITLE  
**INNER PORTION OF THE APPROACH SURFACE RUNWAY 16R**

SHEET NUMBER

**13 OF 20**

DESCRIPTION	EXISTING
PROPERTY LINE	---
PART 77 SURFACE	P177
APPROACH SURFACE	APP
DEPARTURE SURFACE	DEP
PAPI OBSTACLE CLEARANCE SURFACE	3 DEGREES GLIDE PATH
VERTICAL GUIDANCE SURFACE	---
OBSTRUCTION	● 30000

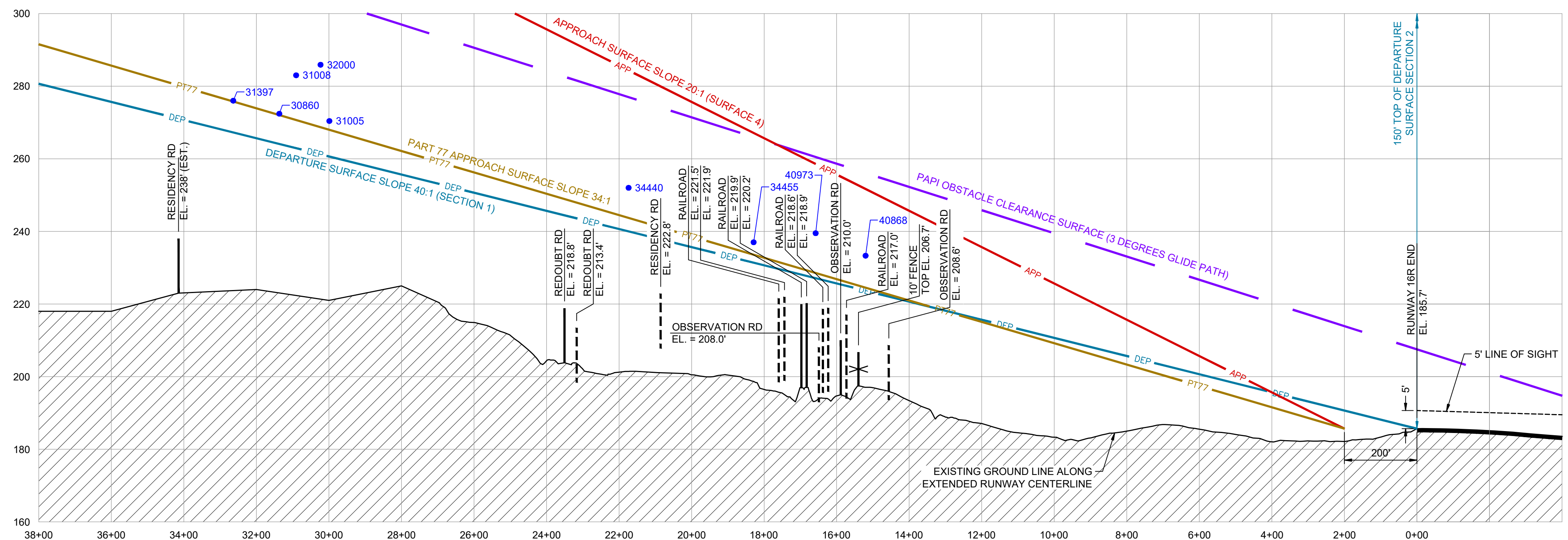
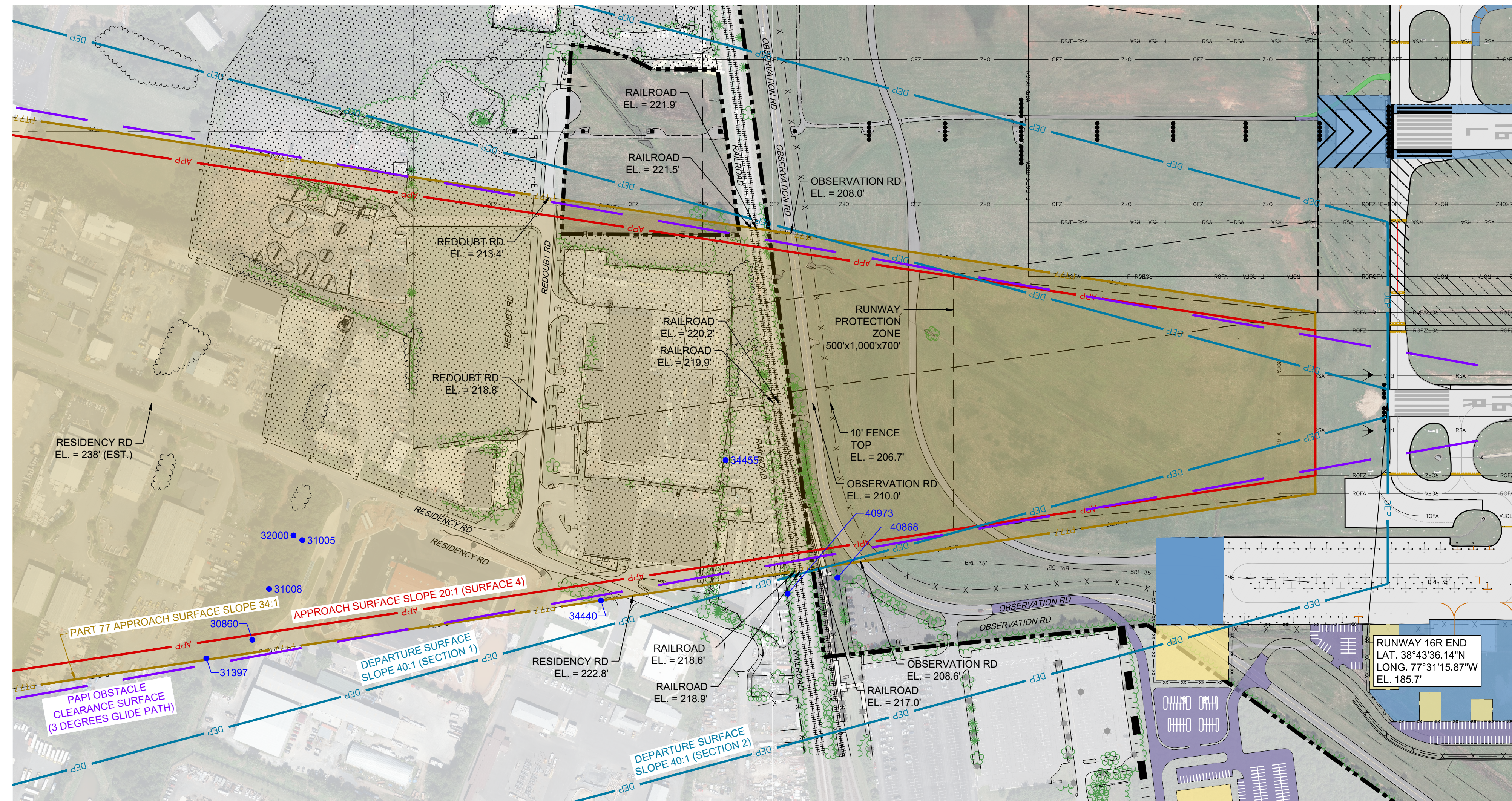

NOTES:  
1. ROADWAY ELEVATIONS INCLUDE TRAVERSEWAY ADJUSTMENT (23' RAILROADS | 17' HIGHWAYS | 15' PUBLIC ROADS | 10' PRIVATE ROADS).

